

- Manifest**
- 20 x leg pair
 - 2 x road closed T2-4
 - 2 x RC/NE/DET
 - 2 x RCA/DA/DET
 - 4 x SRC/DA/DET
 - 4 x detour (L) T5-1 (L)
 - 6 x Bollard
 - 4 x detour (R) T5-1 (R)
 - 2 x pedestrians watch your step T8-1
 - 2 x traffic controller
 - 4 x end detour T2-23

- Legend**
- King Creek Drain
 - ~ Bridge
 - Bollard
 - Fence

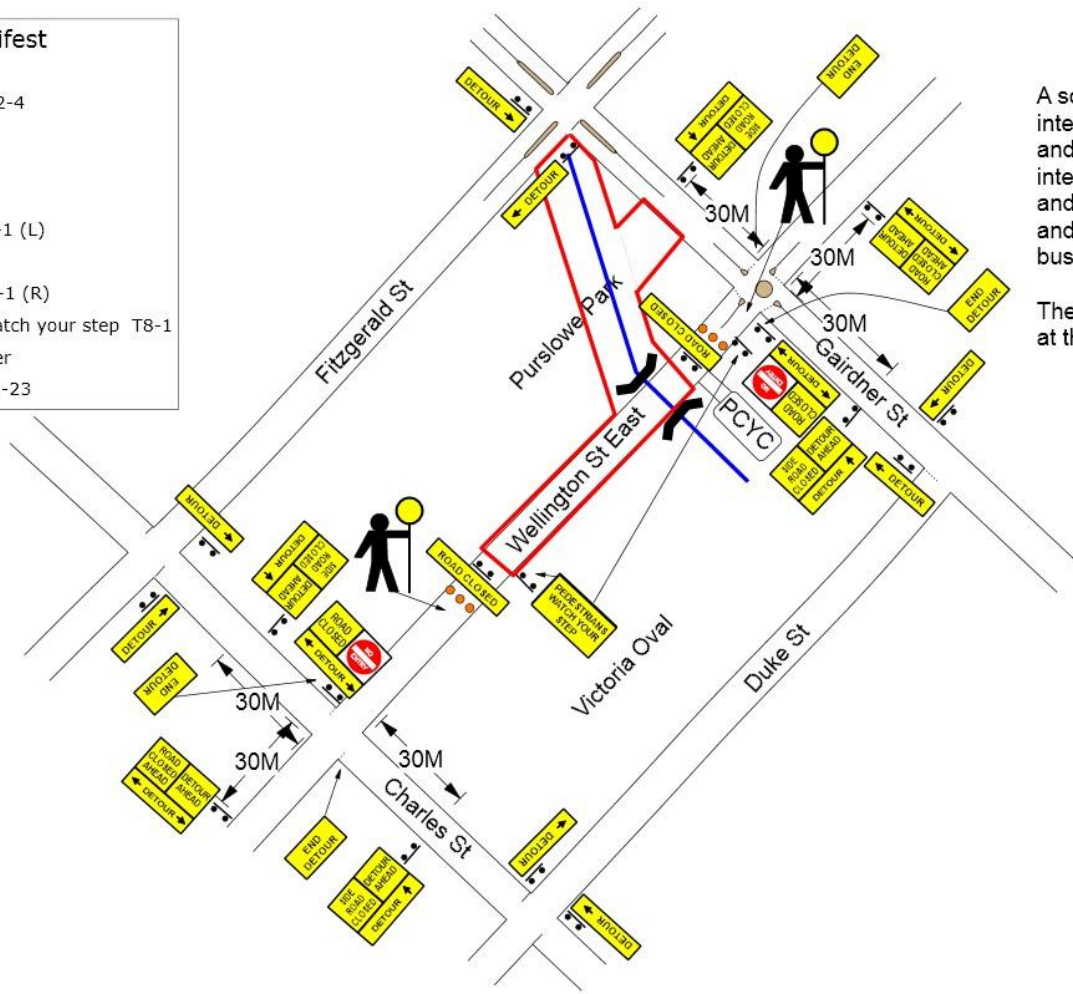

A soft closure to be used at the intersection of Wellington East and Gairdner St and the intersection of Wellington East and Charles St to allow access to PCYC and the Smash Repair and Auto service businesses.

The hard closure is within Wellington St East at the fenced in work site.

RTM Endorsed

Richard Jois (RTM 0028)

Date: 27/06/2017 **Author:** Richard Gibson AWTM 16-12071-03 **Project:** Comiskey's Contracting King Creek Drain Northam Stage 3
Ph: 0488 675 514 **Scale:** Not to Scale

Comments:
 TCD # King Creek Drain-1

Rev # 001

Not to Scale TCD's to be printed on A3 Two way radios required



Traffic controllers are to ensure that all signs are visible and not obstructing footpaths

Traffic controllers shall guide/assist all pedestrians/cyclists and other vulnerable road users safely past the work site.

All existing signage that conflicts with traffic management shall be covered during the works