

Notes:

0.0 DRAWING IS NOT TO SCALE

1.0 PEDESTRIANS WATCH YOUR STEP: sign should be used where the route for pedestrians across incomplete works could be hazardous because of roughness, level differences, or loose or other surface material.

2.0 PEDESTRIANS (arrow): sign shall be used at a work site where it is necessary to direct pedestrians via a particular path.

3.0 USE OTHER FOOTPATH: sign shall be used where works make it necessary to deny use of the footpath on one side of the road.

4.0 LOOK BOTH WAYS, TWO-WAY TRAFFIC: sign to be used where one roadway of a divided road is temporarily closed, this sign shall be placed at non-signalized pedestrian crossings on both sides of the open roadway.

5.0 FOOTPATH CLOSED: shall be used at a footpath which is not in use. The footpath should be closed with barriers.

6.0 POWER LINE WORKS IN PROGRESS: signs shall supplement and not replace the appropriate standard signs and devices. Shall not to be use as advanced warning sign.

7.0 HIGH-VISIBILITY CLOTHING FOR WORK PERSONNEL: sign to ensure high visibility clothing meeting the requirements of AS/NZS 4602 for Types D, N or D/N garments shall be worn by all personnel working in or adjacent to traffic, including traffic at work site.

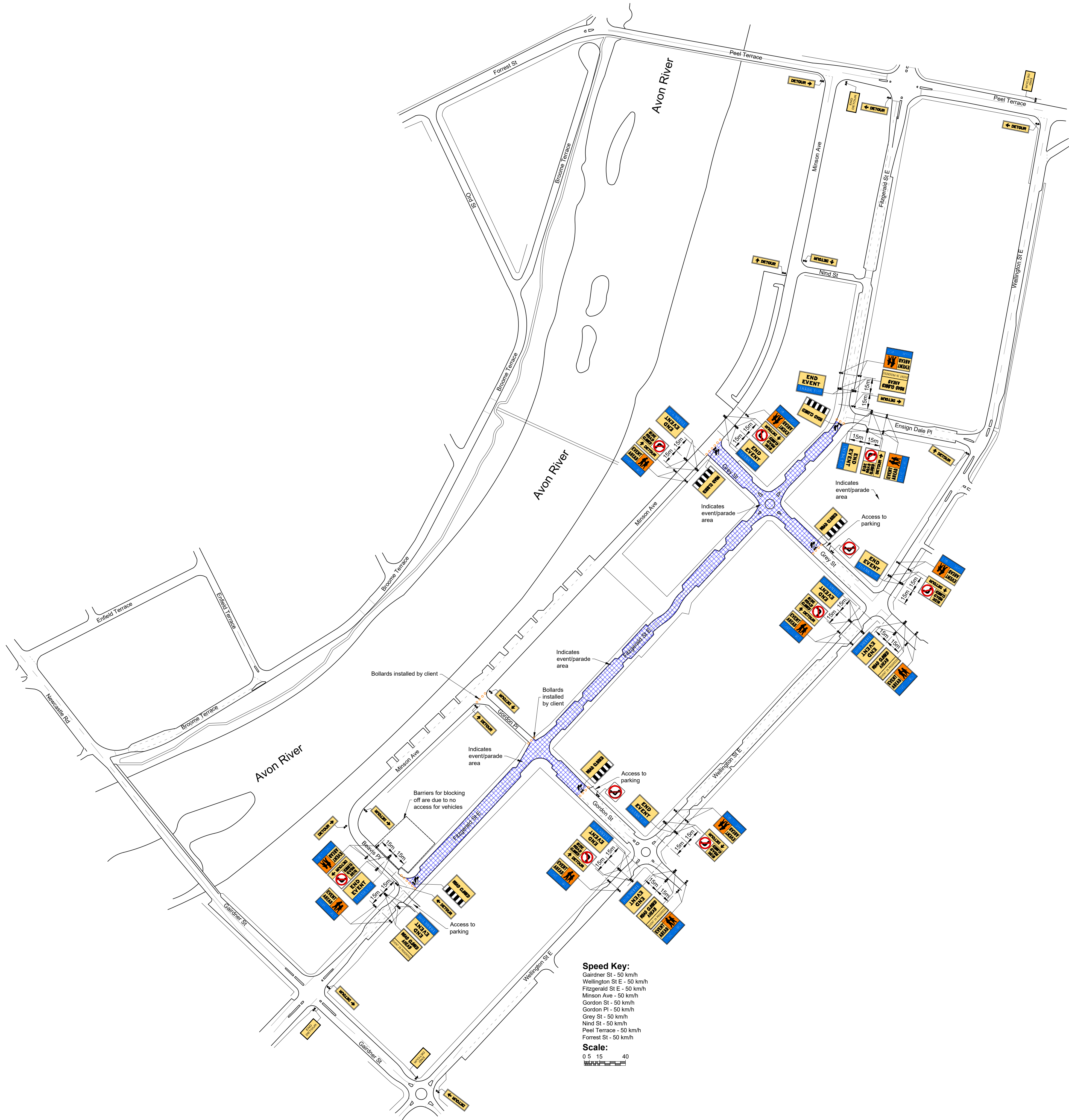

Value of Dimension 'D'	
Speed of Traffic (km/h)	Dimension 'D' (m)
45 or less	0 to 5
46 to 55	15
56 to 65	45
Greater than 65	Equal to speed of traffic in km/h

Recommended Maximum Spacing of Cones Merge Taper		
Purpose and Usage	Traffic Speed (km/h)	Maximum Spacing
Merge Taper	50 or less	4m
	51 - 70	9m
	>70	12m

Recommended Taper Length (m)			
Approximate Speed of Traffic (km/h)	Traffic Control at Beginning of Taper	Lateral Shift Taper	Merge Taper
45 or less	15	0	15
46 to 55	15	15	30
56 to 65	30	30	60
66 to 75	N/A	70	115
76 to 85	N/A	80	130
86 to 95	N/A	90	145
96 to 105	N/A	100	160
Greater than 105	N/A	110	180

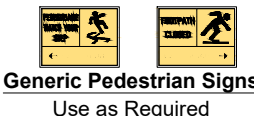

Generic Pedestrian Signs
Use as Required

CF.QF.056 Site Specific Drawing
Issue: 0912/056 Rev 1
For the most current version of this controlled document please refer to the Contraflow data server



Contraflow Head Office
47 Austin Ave, Maddington 6109
Ph: 1300 789 692
Email: bookings@contraflow.com.au

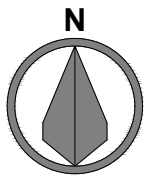

	Name	Accreditation	Date	Signature	Drawing No.	TCD - 001
Designed by:	Scott Ferrell	AWTM - 15 - 0180 - 01	09.06.2017		Title	Traffic Control Diagram
Drafted by:	Jun Tai		09.06.2017		Location	Minson Ave, Northam
Checked by:	Mariele Day	AWTM - 14 - 40535 - 01	09.06.2017		Client / Local Authority	Shire of Northam
					Revision & Issue	Rev 01

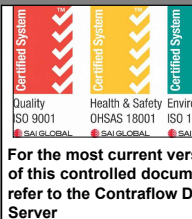

For the most current version of this controlled document refer to the Contraflow Data Server